

SYNTHETIC GRASS TORCH ON ASPHALT ROOF & PATIO SYSTEM

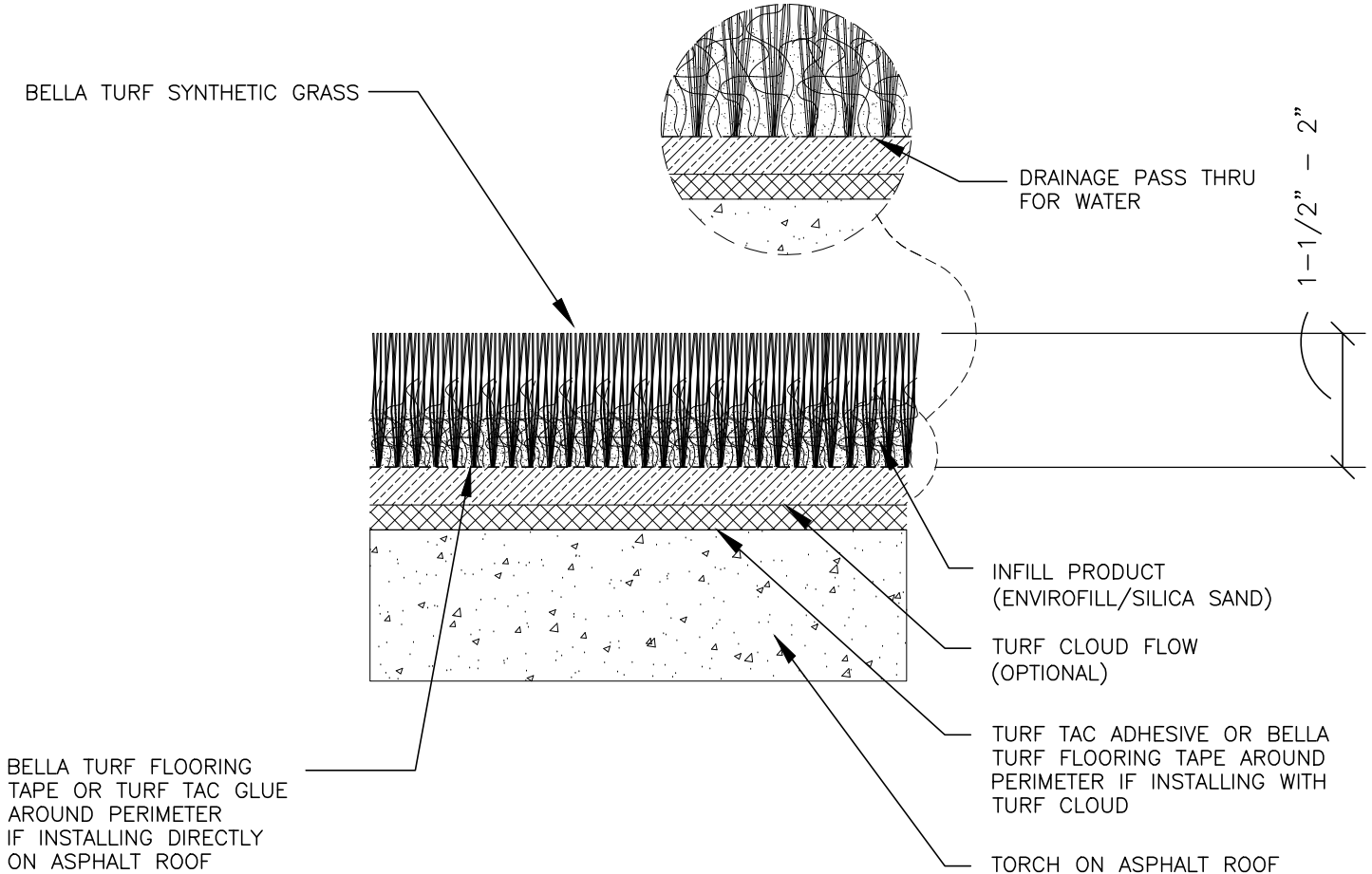

GENERAL NOTES:

- GLUE DOWN OR USE BELLA TURF FLOORING TAPE AROUND PERIMETER TO ASPHALT ROOF
- GLUE DOWN OF GRASS BACKING AROUND PERIMETER TO TURF CLOUD FLOW IF APPLICABLE
- SYNTHETIC GRASS PRODUCT INSTALLED WITH GRAIN OF THE FIBRES ALL RUNNING IN THE SAME DIRECTION
- JOINT SEAMS (IF REQUIRED) AS PER MANUFACTURERS RECOMMENDATIONS. REMOVE THREE STITCHES FROM BOTH SIDES OF GRASS AND SEAM TO AN 1/8" GAP TO SIMULATE TUFT GAUGE. CUT TIGHT TO STITCH
- INFILL PRODUCT APPLIED TO REQUIRED AMOUNT AS PER MANUFACTURERS RECOMMENDATION
- 1-1/2 TO 2 LBS. OF ENVIROFILL/SILICA SAND PER SQUARE FOOT
- INSTALLATION OF PRODUCT TO BE AS PER THE MANUFACTURERS RECOMMENDATIONS
- DRAWING NOT TO BE SCALED

Bella Turf

Tel. (604)385-4727

#107 - 19347 24th Ave.

Surrey, BC

V3Z 3S9

Tel. (905)276-7333

#5-6 - 600 Orwell St.

Mississauga, ON

L5A 3R9

1-888-970-8771

www.bellaturf.ca